

CITROCASA 8000 XB ADVANCE

Juice tank for even more convenience.

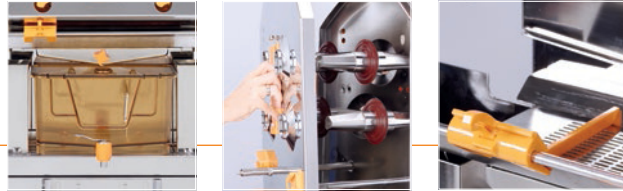

Ideal for highly frequented establishments and staff-operated juicing.

The ideal juicing solution when you have to press larger quantities of juice in advance. The juice is pressed into the juice tank with a capacity of approx. 5 liters (1.3 gal.)

- High-capacity stainless steel fruit hopper and rotation plate for 21 kg (46.2 lbs) of oranges
- Large digital display with counter for squeezed fruits
- Programming quantity of fruits and On/Off operation
- Ideal for Stand-Alone-Solutions
- SCS Soft Cutting System for superior tasting juice
- Double Cover and Cross Holder for fast and easy cleaning
- The MTS (Manual-Transport-System) to keep sieve free of seeds and pulp
- Intelligent stop for improved peel management

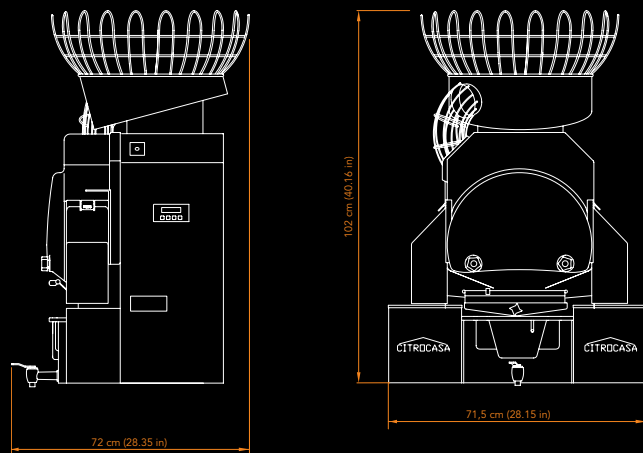

CITROCASA 8000 XB ADVANCE – Technical Specifications

Fruit per minute	Fruit supply	Optimal fruit size	Measurements (H x W x D)	Net weight	Power	Protection	Fuse
40 pcs.	21 kg / 46.2 lbs	Ø 65 – 80 mm / 2.56 – 3.14 in	w/o cabinet 102 x 71.5 x 72 cm / 40.16 x 28.15 x 28.35 in incl. cabinet 180.5 x 67.5 x 73 cm / 71.06 x 26.57 x 28.74 in	w/o cabinet 72 kg / 158.7 lbs incl. cabinet 111 kg / 244.7 lbs	0.28 W	IPx1	6.3 A